

100 ° Flat Head

Screw Size	3-Wing	Ribbed 3-Wing	Reference Penetration inch/mm	Diameter inch/mm	Length inch/mm
2	3W2-1-1	3WR2-3101	.040/1.02	.438/11.12	1.000/25.40
4	3W4-1-1	3WR4-3101	.040/1.02	.438/11.12	1.000/25.40
6	3W6-1-1	3WR6-3101	.049/1.24	.438/11.12	1.000/25.40
8	3W8-1-1	3WR8-3101	.059/1.49	.563/14.30	1.000/25.40
10	3W10-1-1	3WR10-3101	.075/1.91	.563/14.30	1.000/25.40
1/4	3W1/4-1-1	3WR1/4-3101	.082/2.08	.875/22.23	1.000/25.40
5/16	3W5/16-1-1	3WR5/16-3101	.090/2.29	.875/22.23	1.000/25.40
3/8	3W3/8-1-1	3WR3/8-3101	.116/2.95	1.000/25.40	1.000/25.40

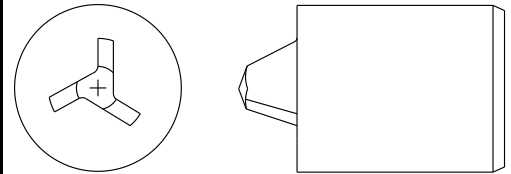

100 ° Oval Head

Screw Size	3-Wing	Ribbed 3-Wing	Reference Penetration inch/mm	Diameter inch/mm	Length inch/mm
2	3W2-3-1	3WR2-3104		.438/11.12	1.000/25.40
4	3W4-3-1	3WR4-3104		.438/11.12	1.000/25.40
6	3W6-3-1	3WR6-3104		.438/11.12	1.000/25.40
8	3W8-3-1	3WR8-3104		.563/14.30	1.000/25.40
10	3W10-3-1	3WR10-3104		.563/14.30	1.000/25.40
1/4	3W1/4-3-1	3WR1/4-3104		.875/22.23	1.000/25.40
5/16	3W5/16-3-1	3WR5/16-3104		.875/22.23	1.000/25.40
3/8	3W3/8-3-1	3WR3/8-3104		1.000/25.40	1.000/25.40

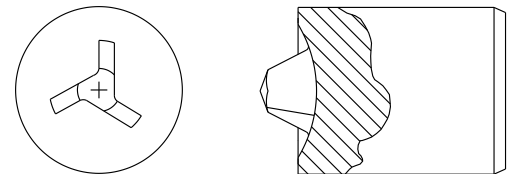

Flat Pan Head

Screw Size	3-Wing	Ribbed 3-Wing	Reference Penetration inch/mm	Diameter inch/mm	Length inch/mm
2	3W2-11-1	3WR2-3106		.438/11.12	1.000/25.40
4	3W4-11-1	3WR4-3106		.438/11.12	1.000/25.40
6	3W6-11-1	3WR6-3106		.438/11.12	1.000/25.40
8	3W8-11-1	3WR8-3106		.563/14.30	1.000/25.40
10	3W10-11-1	3WR10-3106		.563/14.30	1.000/25.40
1/4	3W1/4-11-1	3WR1/4-3106		.875/22.23	1.000/25.40
5/16	3W5/16-11-1	3WR5/16-3106		.875/22.23	1.000/25.40
3/8	3W3/8-11-1	3WR3/8-3106		1.000/25.40	1.000/25.40

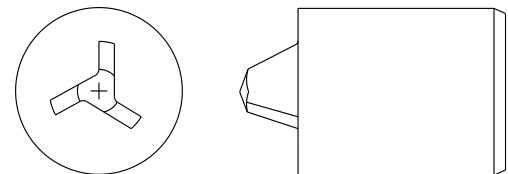

1. Punch materials:
 - M2 at RC 62-64
 - M42 at RC 63-65
2. Punches available with headmarking and company logo. Please specify when ordering.
3. PVD Coatings available for cold & hot heading applications.